

HÄFELE



www.hafeleindia.com

MATRIXBOX SLIM



MATRIXBOX SLIM

1

MatrixBox Slim



The **MatrixBox Slim** drawer system by Häfele comes with a sophisticated slim design and operates smoothly, opens swiftly and closes with precision.

This Slim drawer system with 13mm thin drawer sides, features simple assembly as well as unrivalled design and flexibility in application. It is suitable for installation in kitchens, bedrooms and bathrooms. MatrixBox Slim comes with 3 height options, 2 side design options (Solid & Décor) and 2 weight carrying capacities (40 & 60 kg); giving you the widest choice for a host of applications. With an integrated Soft-Close and a Synchronized Runner Technology, the movement of these drawers is smooth, stable and precise. The attractive Graphite Grey Finish brings sophistication and elegance to your home design.

MATRIXBOX SLIM



ADVANTAGES OF MATRIXBOX SLIM



EASY ASSEMBLY

With the MatrixBox Slim Drawer System there are no additional preparations needed for the bottom panel, unlike other systems that require a specific grooving for the runner installation. This makes the overall assembly hassle-free and quick; and leaves very little room for manual errors. You can comfortably adjust the height and side positions of the drawer front from the adjustment options available on the inside of the drawer



VERSATILE DESIGN

The MatrixBox Slim Drawer System comes in an attractive Graphite Grey finish along with two drawer side options – Solid (a complete metal side) and Décor (that provides the option to add a decorative panel to the drawer side). This presents an opportunity to create the most versatile design applications with this system. For inner drawers, MatrixBox Slim offers a host of front options that add to the versatility of this range.



EXTENSIVE RANGE

The MatrixBox Slim Drawer System comes with three height options, two variants for the drawer sides (i.e. Solid and Décor), two weight carrying capacities of 40kg and 60 kg and a host of front options for inner drawers. This extensive combination provides for a wide choice of applications.



EXCELLENT PERFORMANCE

The MatrixBox Slim Drawer Systems display optimised running and closing characteristics due to synchronized runners with an integrated fluid damper and a cushioned end stop in the open position. The stable, smooth and balanced motion of these drawer systems provide for an exceptional performance.



VARIABLE USAGE

The slim and straight design of the drawer sides makes MatrixBox Slim the perfect choice for different applications of the home be it kitchen drawers, bedroom furniture and wardrobes, living room units or bathroom storage. The weight carrying capacities and universal design add to the flexibility of this range



GERMAN QUALITY

The Matrixbox Slim Drawer Systems by Hafele are tested for 60,000 cycles, which meet the LGA certification requirements. They additionally come with the best operating characteristics, inherent elegant motions and smooth closing in accordance with the well-known Hafele quality standards.

MATRIXBOX SLIM

1

MatrixBox Slim



Standard Drawers



Inner Drawers

- Ideal for kitchen drawers, bedroom furniture and wardrobes, living room units bathroom storage or any other pull-out applications
- Slim 13mm drawer sides with two side variants - Solid (a complete metal side) and Décor (that provides the option to add a decorative panel to the drawer side).
- Height and Side Adjustment available from inside of the drawer
- Smooth synchronised runner movement
- Aesthetic inner drawer design with complementary Solid and Décor Front Options
- 60000 cycle tested

- Material: Steel
- Finish: Graphite Grey
- Type of Pull-out: Full Extension with integrated Soft-Close
- Weight Carrying Capacities: 40 kg & 60 kg

Drawer Side Options



Solid Drawer Side



Décor Drawer Side

The Three-two-one Range (Heights, Weight-carrying Capacities & Finish):

Three Drawer Heights:

The MatrixBox Slim comes in 3 heights options: H1 (88mm), H2 (193mm) and H3 (257mm). The H2 MatrixBox Slim Drawers are further available in two drawer side options of Solid and Décor.

Two Weight Carrying Capacities:

The MatrixBox Slim comes in 2 weight-carrying capacities of 40kg and 60kg.

One Attractive Finish:

The attractive Graphite Grey finish of the MatrixBox Slim provides elegance and a sophisticated look to the overall design.

These options combined with a host of nominal lengths available in the range, make the MatrixBox Slim a holistic solution for different home applications.

MATRIXBOX SLIM

Standard Drawer Application

Components:

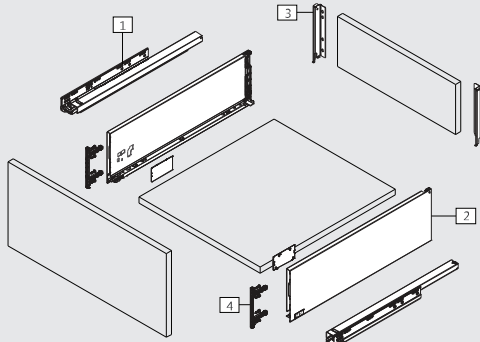

Components: Solid Drawer Side

1. Drawer Runners
 2. Drawer Sides (as per heights H1, H2 & H3)
 3. Rear-fixing Brackets (as per heights H1, H2 & H3)
 4. Front-fixing Brackets (as per heights H1, H2 & H3)
- This set also includes the internal and external cover caps

Components: Décor Drawer Side

1. Drawer Runners
 2. Drawer Sides for Décor element (as per height H2)
 3. Rear-fixing Brackets (as per height H2)
 4. Front-fixing Brackets (as per height H2)
 5. Front Adapter
 6. 10 mm Glass insert (not part of the set)
 7. Rear Adapter
- This set also includes the internal and external cover caps

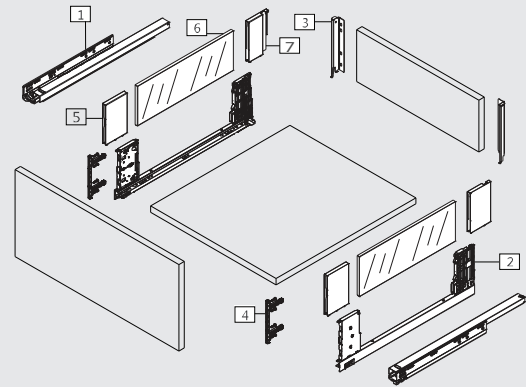

Planning – Space Requirement

MATRIXBOX SLIM H1

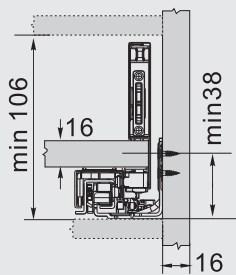

Space requirement in cabinet

MATRIXBOX SLIM H2

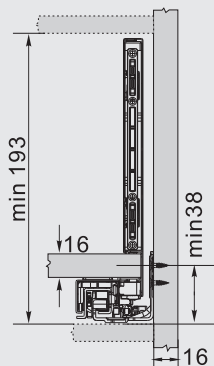

MATRIXBOX SLIM H3

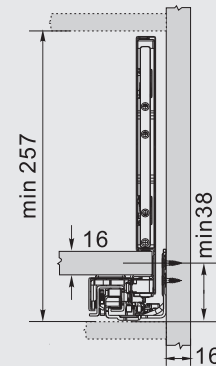

Cutting dimensions – Décor side

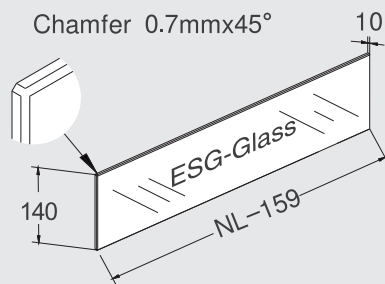

Glass Side Dimensions For Matrixbox Slim H2 Decor (Mm)

10mm Glass-boxside

Length = nominal length of cabinet runner – 159 mm
Height = 140 mm

MATRIXBOX SLIM

MatrixBox Slim

1

Inner Drawer Application

Components:

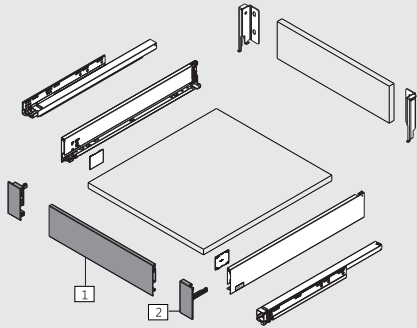

Components: Solid Front for H1 Drawer Side

1. Front Section
 2. Front-fixing Brackets (H1 height)
- The other components remain the same as the Standard H1 Drawer System

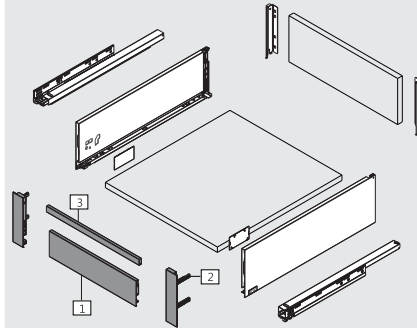

Components: Solid Front for H2 Drawer Side

1. Front Section
 2. Front-fixing Brackets (H2 height)
 3. Square Cross Rail
- The other components remain the same as the Standard H2 Drawer System (with Solid or Décor Sides)

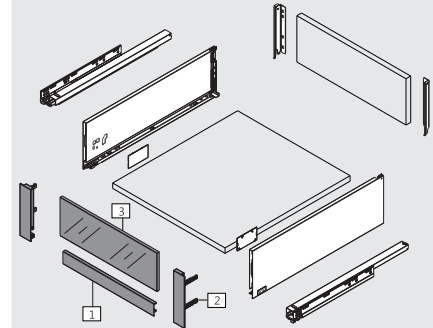

Components: Décor Front for H2 Drawer Side

1. Front Section
 2. Front-fixing Brackets (H2 height)
 3. 10 mm Glass insert (not part of the set)
- The other components remain the same as the Standard H2 Drawer System (with Solid or Décor Sides)

Note: The Space Requirement Planning and cutting-dimensions for the side Décor panel remain the same as the Standard Drawer

Square Cross Rail for Solid Front

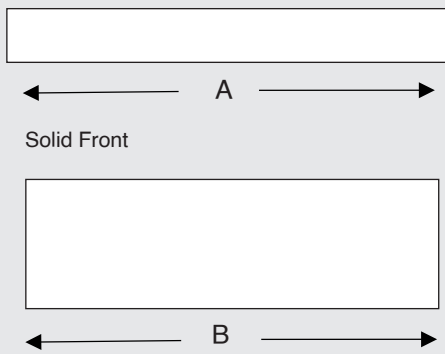

- A = Cabinet Width – 72 mm
 B = Cabinet Width – 97 mm
 Note: The Square Cross Rail for Solid Front is required only for H2 height option.

Décor Front

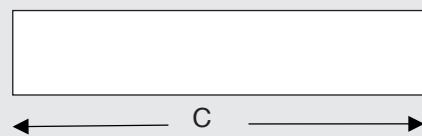

- C = Cabinet Width – 97 mm
 Thickness = 10 mm

MATRIXBOX SLIM

Drilling Pattern for Cabinets

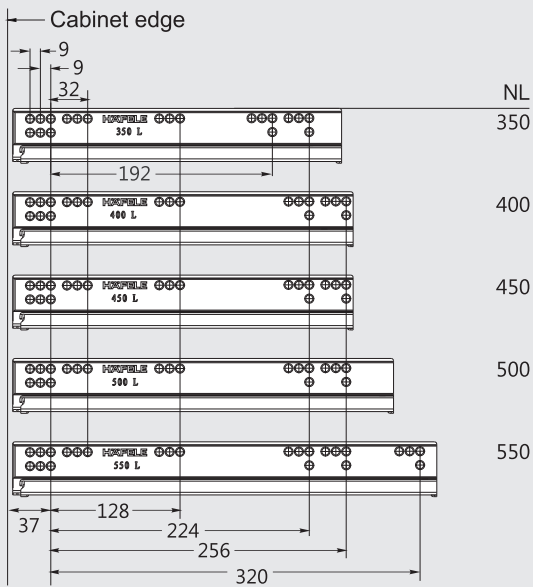

Internal Cabinet Depth:

Internal cabinet Depth = $LT = NL + 3$

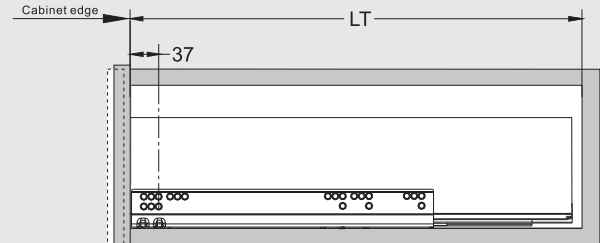

Internal Cabinet Depth (LT) = Nominal Length of Runner (NL) + 3 mm

Cutting dimensions for base and rear panels (panel thickness of 16mm):

Base Panel

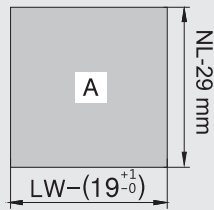

Base Panel Width = Internal Cabinet Width (LW) – 19 mm
 Base Panel Depth = Nominal Length of Runner (NL) – 29 mm

Rear Panel

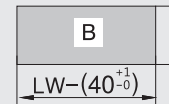

Rear Panel Width = Internal Cabinet Width (LW) – 40 mm

	H1	H2	H3
Rear Panel Height (mm):	63	148	212

Calculation of the Internal Drawer Space Dimensions:

Internal drawer width = External Cabinet width - (2 X side panel thickness) – 40mm

Example (Let's assume that the External Cabinet Width = 600mm and Side Panel Thickness = 18 mm)
 Internal drawer width = $600 - (2 \times 18) - 40$
 Internal drawer width = $600 - 36 - 40$
 Internal drawer width = 524 mm

Internal drawer depth = Nominal length of Runner – 29mm

Example (Let's assume that the Nominal Length of the runner = 500mm)
 Internal drawer depth = $500 - 29$
 Internal drawer depth = 471 mm

MATRIXBOX SLIM

1

ORDERING INFORMATION

MatrixBox Slim



MATRIXBOX SLIM - H1 STANDARD DRAWERS

1

MatrixBox Slim

Standard H1 (88mm) Drawer Set

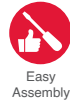

Easy Assembly



Extensive Range



Versatile Design



Variable Usage



Excellent Performance



German Quality

- > Material: Steel
- > Finish: Graphite Grey
- > Type of Pull-out: Full Extension with integrated Soft-Close
- > Weight Carrying Capacities: 40 kg

Ordering

40 kg Systems

Nominal Length	Article Number
350 mm	554.00.802
400 mm	554.00.803
450 mm	554.00.804
500 mm	554.00.805
550 mm	554.00.806

Installation Dimensions

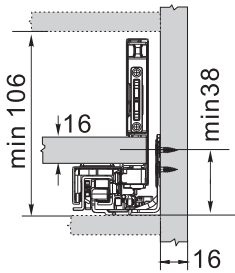

Space requirement in cabinet

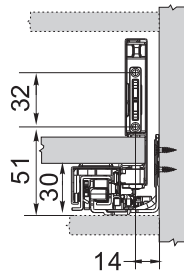

Front installation dimensions

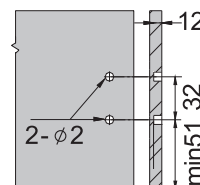

Front drilling dimensions

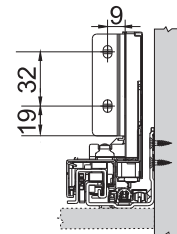

Back installation dimensions

Adjustments:

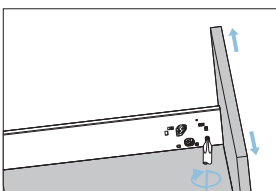

Left & right adjustment

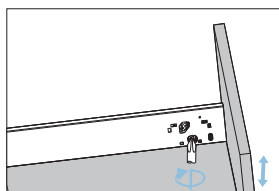

Up & Down adjustment

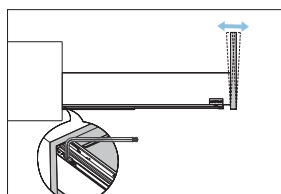

Tilt adjustment (by M3 Allen key)

Removal of Front:

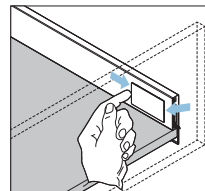

Tip up the cover and pull out

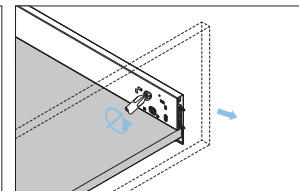

Turn screw driver to release the drawer front

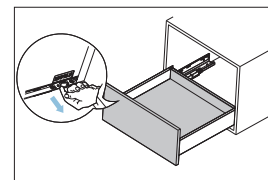

Press the locking device under drawer bottom and pull out the drawer

MATRIXBOX SLIM - H2 STANDARD DRAWERS

1

MatrixBox Slim

Standard H2 (193mm) Drawer Set with Solid Drawer Side



- > Material: Steel
- > Finish: Graphite Grey
- > Drawer Side: Solid
- > Type of Pull-out: Full Extension with integrated Soft-Close
- > Weight Carrying Capacities: 40 kg & 60 kg

Ordering

Nominal Length	40 kg Systems	60 kg Systems
	Article Number	
350 mm	554.01.802	-
400 mm	554.01.803	-
450 mm	554.01.804	-
500 mm	554.01.805	554.01.905
550 mm	554.01.806	554.01.906

Installation Dimensions

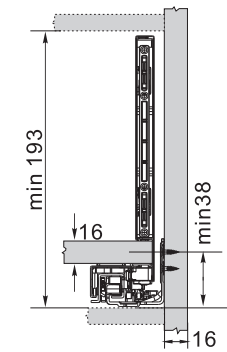

Space requirement in cabinet

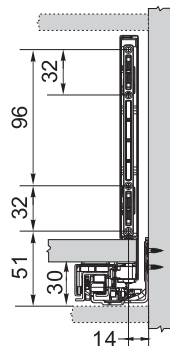

Front installation dimensions

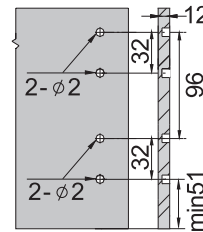

Front drilling dimensions

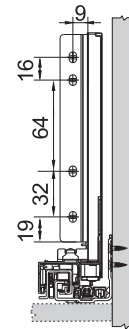

Back installation dimensions

Adjustments:

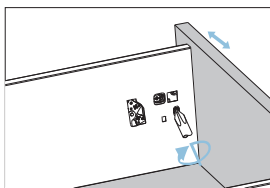

Left & right adjustment

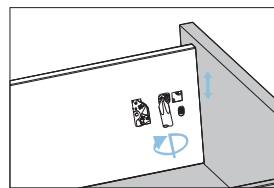

Up & Down adjustment

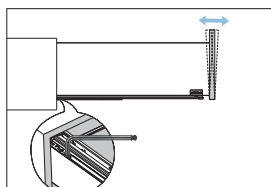

Tilt adjustment (by M3 Allen key)

Removal of Front:

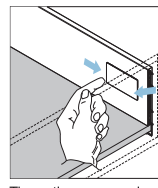

Tip up the cover and pull out

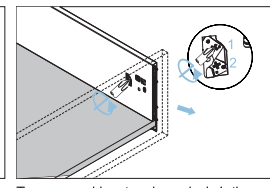

Turn screw driver to release lock 1, then release lock 2, remove the drawer front

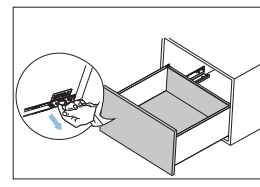

Press the locking device under drawer bottom and pull out the drawer

MATRIXBOX SLIM - H2 STANDARD DRAWERS

Standard H2 (193mm) Drawer Set with Décor Drawer Side



- > Material: Steel
- > Finish: Graphite Grey
- > Drawer Side: Décor
- > Type of Pull-out: Full Extension with integrated Soft-Close
- > Weight Carrying Capacities: 40 kg

Ordering

40 kg Systems	
Nominal Length	Article Number
500 mm	554.01.845
550 mm	554.01.846

Installation Dimensions

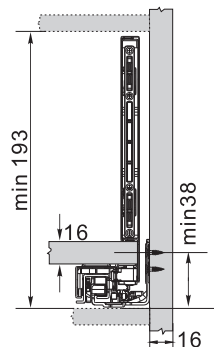

Space requirement in cabinet

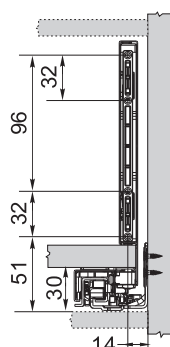

Front installation dimensions

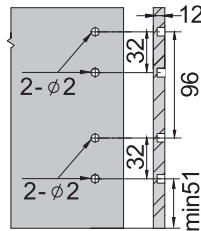

Front drilling dimensions

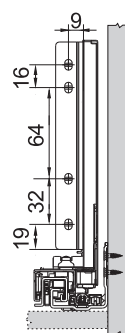

Back installation dimensions

Cutting dimensions – Décor side

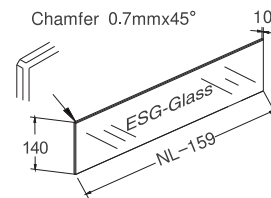

Adjustments:

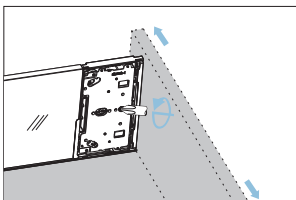

Left & right adjustment

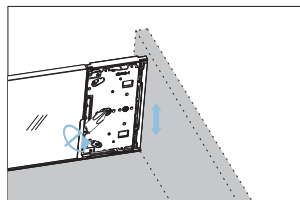

Up & Down adjustment

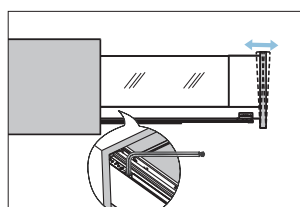

Tilt adjustment (by M3 Allen key)

Removal of Front:

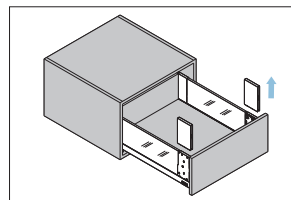

Pull out front cover

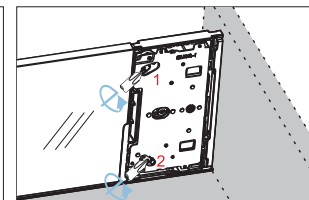

Turn screw driver to release lock 1, then release lock 2, remove the drawer front

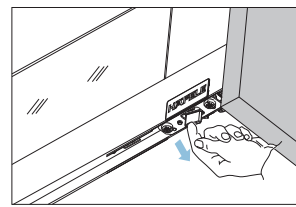

Press the locking device under drawer bottom and pull out the drawer

MATRIXBOX SLIM - H3 STANDARD DRAWERS

1

MatrixBox Slim

Standard H3 (257mm) Drawer Set



Easy Assembly



Extensive Range



Versatile Design



Variable Usage



Excellent Performance



German Quality

- > Material: Steel
- > Finish: Graphite Grey
- > Type of Pull-out: Full Extension with integrated Soft-Close
- > Weight Carrying Capacities: 40 kg & 60 kg

Ordering

Nominal Length	40 kg Systems:	60 kg Systems:
	Article Number	
500 mm	554.01.825	554.01.925
550 mm	554.01.826	554.01.926

Installation Dimensions

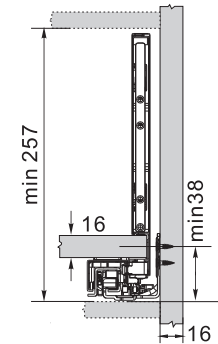

Space requirement in cabinet

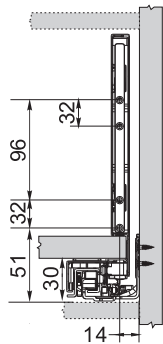

Front installation dimensions

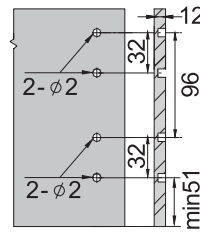

Front drilling dimensions

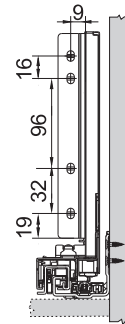

Back installation dimensions

Adjustments:

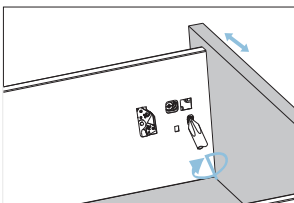

Left & right adjustment

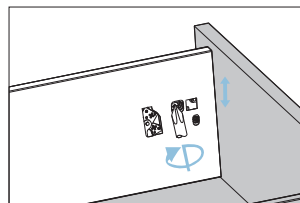

Up & Down adjustment

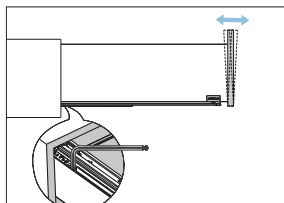

Tilt adjustment (by M3 Allen key)

Removal of Front:

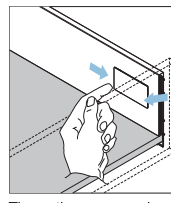

Tip up the cover and pull out

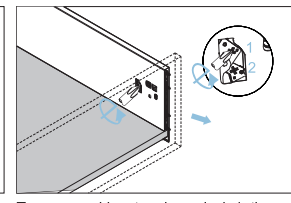

Turn screw driver to release lock 1, then release lock 2, remove the drawer front

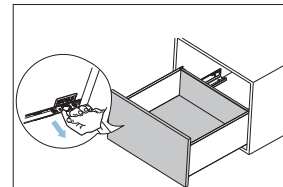

Press the locking device under drawer bottom and pull out the drawer

MATRIXBOX SLIM - INNER DRAWERS

H1 (88 mm) Inner Drawer Solid Front Set



- > Material: Steel
- > Finish: Graphite Grey
- > Type of Pull-out: Solid

Ordering

Article Number	Cabinet Width
552.19.590	600 mm
552.19.591	1200 mm

MatrixBox Slim Sets – Pick H1 Standard drawer configuration sets that best suit your requirements from page (1.46)
 + Choose the Solid Front Set from the table above as per the Cabinet Width:

H2 (193 mm) Inner Drawer Solid Front Set



- > Material: Steel
- > Finish: Graphite Grey
- > Type of Pull-out: Solid + Square Cross Rail

Ordering

Article Number	Cabinet Width
552.19.570	600 mm
552.19.571	1200 mm

MatrixBox Slim Sets – Pick H2 Standard drawer configuration sets that best suit your requirements from pages (1.47 and 1.48)
 + Choose the Solid Front Set from the table above as per the Cabinet Width:

H2 (193 mm) Inner Drawer Décor Front Set



- > Material: Steel
- > Finish: Graphite Grey
- > Type of Pull-out: Décor

Ordering

Article Number	Cabinet Width
552.19.596	600 mm
552.19.597	1200 mm

MatrixBox Slim Sets – Pick H2 Standard drawer configuration sets that best suit your requirements from pages (1.47 and 1.48)
 + Choose the Décor Front Set from the table above as per the Cabinet Width:

MATRIXBOX SLIM - UNDER SINK UNIT

MatrixBox Slim

1

Under Sink Unit



Easy Assembly



Versatile Design



Variable Usage



Excellent Performance



German Quality

- > Material: Plastic
- > Finish: Dark Grey
- > Suitable for: Drawers with 16mm base and rear panel

Ordering

Description	Article Number
Basic Module – H-frame, 2 transverse profiles with connector, fixing rail for trays and rear brackets	556.23.668
Storage trays	556.23.428

Components and installation dimensions

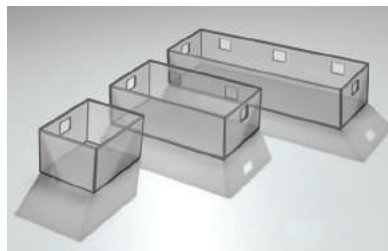

Storage Trays

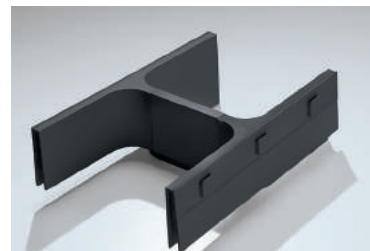

Basic Module

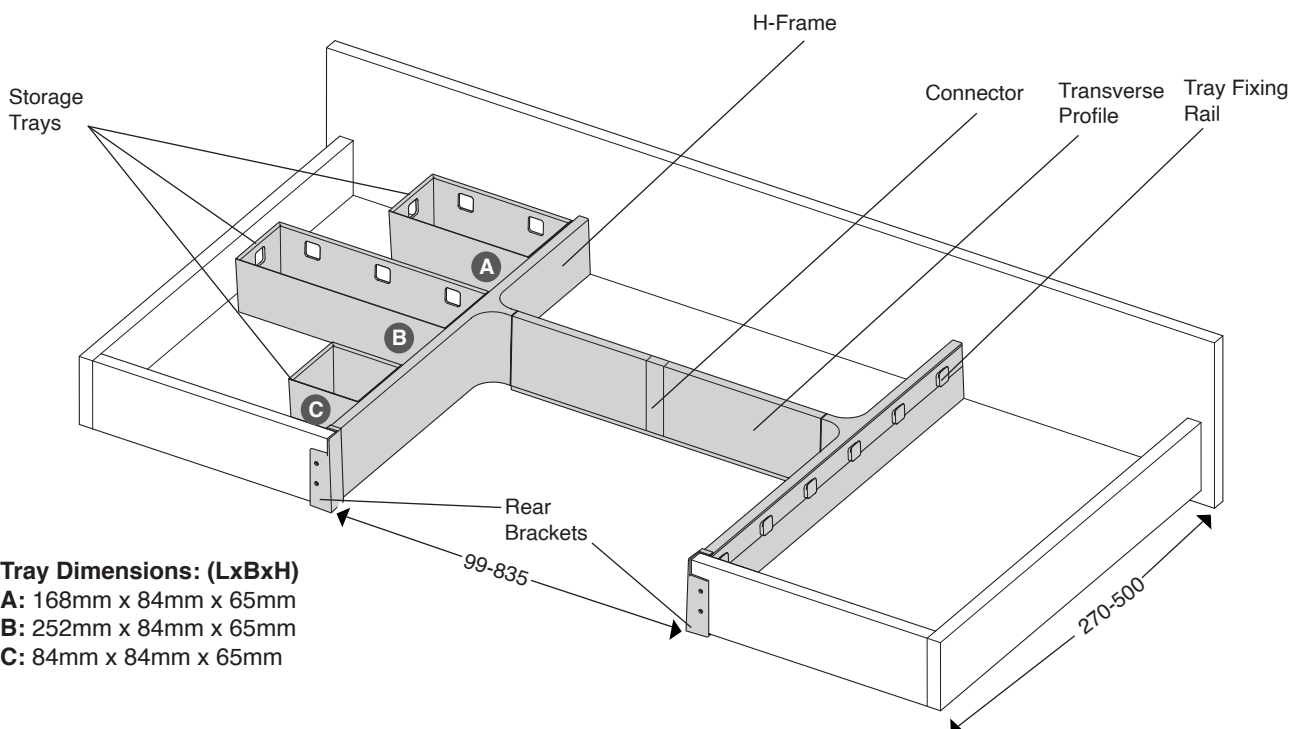



- > Ideal for maximum utilization of the under-sink space
- > This under sink organization system consists of a unique H-shaped frame to conceal sink cut-out and 3 storage trays
- > Storage trays are easy to clean and impact resistant. These trays come in 3 different sizes that can be configured to suit individual's requirement. They can either be secured in place with fixing rail or can be used as freestanding units
- > Maximum cut-out width can be extended to 835mm using the connector and transverse profile which are included in the package



SCAN ME